

Waveguide Adapter, Type N Coax

GERLING

Model GA2011
Model GA2012

GAE offers a series of high power waveguide to coax transitions that deliver high performance at high microwave power levels. Models GA2011 and GA2012 utilize the grounded loop method of terminating the coaxial center conductor, thus increasing the breakdown voltage far beyond the limit of non-terminated designs. The power rating is limited only by the rating of the coaxial cable (provided by the customer) attached to the Type N connector, which in most cases does not exceed 1 kW.

General Specifications:

Frequency	2450 MHz +/- 50 MHz
Input Power	1 kW continuous max. (output to matched load)
Waveguide	GA2011: WR340 (RG113/U) GA2012: WR430 (RG105/U)
Waveguide Flange	GA2011: UG554/U GA2012: UG437B/U
Coax Connector	Type N female
Input VSWR	1.2 max.
Insertion Loss	.13 dB max
Construction	Aluminum waveguide body; Brass coax connector and center conductor
Finish	Chemical film; black textured paint

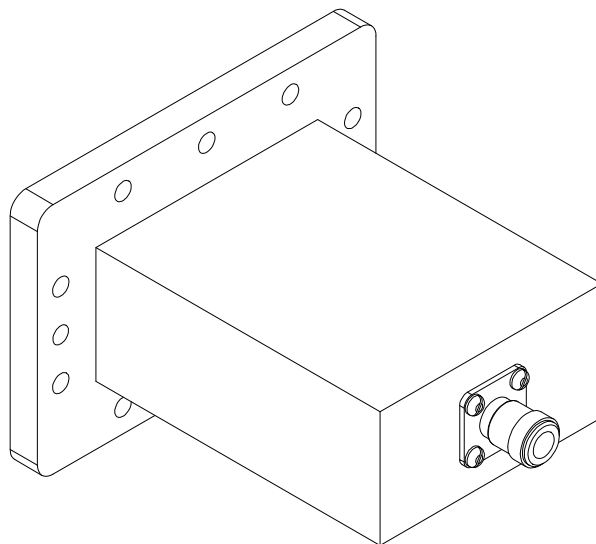

Options:

- ◆ Threaded inserts or studs on flange (any combination)
- ◆ Flange interlock switch

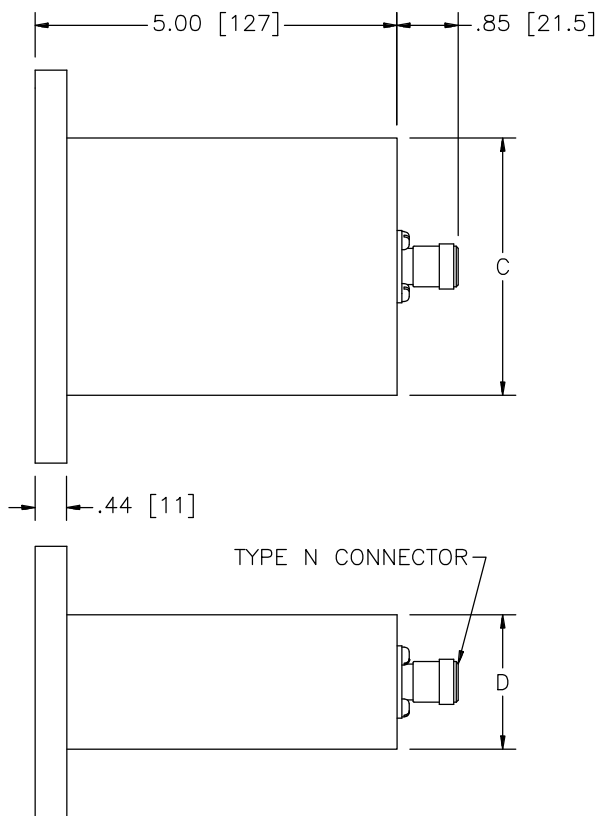

	GA2011	GA2012
WAVEGUIDE	WR340	WR430
A	5.44 [138]	6.34 [161]
B	3.75 [95]	4.19 [106]
C	3.56 [90]	4.46 [113]
D	1.86 [47]	2.31 [59]
E	UG554/U	UG437B/U

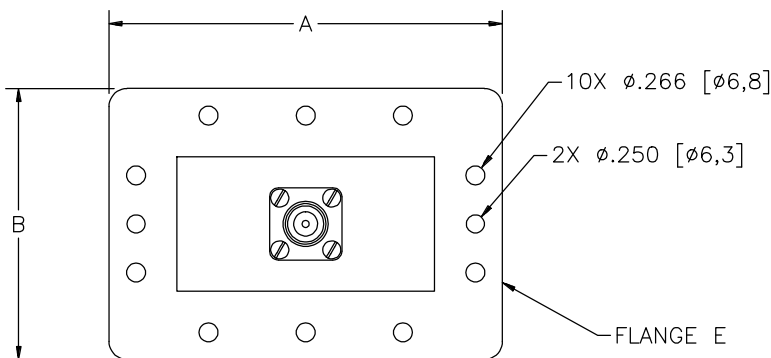

GERLING APPLIED ENGINEERING, INC.

© 2003-2009 Gerling Applied Engineering, Inc.
PO Box 580816 • Modesto, CA 95358 • USA
Phone: +1-209-527-8960 • Fax: +1-209-527-5385
E-mail: sales@2450MHz.com • Web: www.2450MHz.com