

Flexible Waveguide, CPR284

GERLING

Model GA2101

Specifications:

Waveguide	WR284
Flange	CPR284F (UG1725/U)
Material	6061-T6 aluminum flanges, corrugated copper waveguide
Finish (flanges only)	Clear chemical film (Alodine 1000) per MIL-C-5541, Class 1A
VSWR	1.10 max.
Insertion Loss	.02 dB/ft max.
Length A (min/max)	4.00 (102); 48.00 (1219)
Bend Radius (min)	E-plane: 4" (102); H-plane: 12" (306)
Max. Twist	7.5°/in. (3°/cm)

Options:

- ◆ Flange interlock switches

Ordering Information:

Model Number Format: **GA2101-X.XX**
 X.XX = "A" dimension (inches)

Optional threaded inserts: Add "H" or "M" after dimension suffix for threaded inserts in one flange only, "HH" or "MM" for inserts in both flanges (H = 1/4-20 UNC; M = M6 metric)

Example: **GA2101-12.00H** designates Flexible Waveguide, CPR284, 12" long with inserts in one flange only

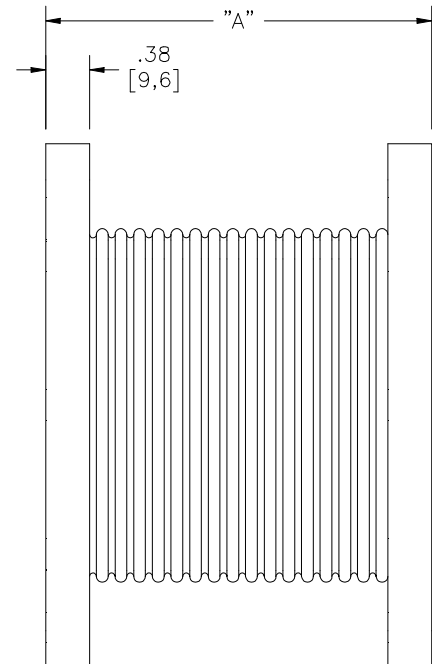
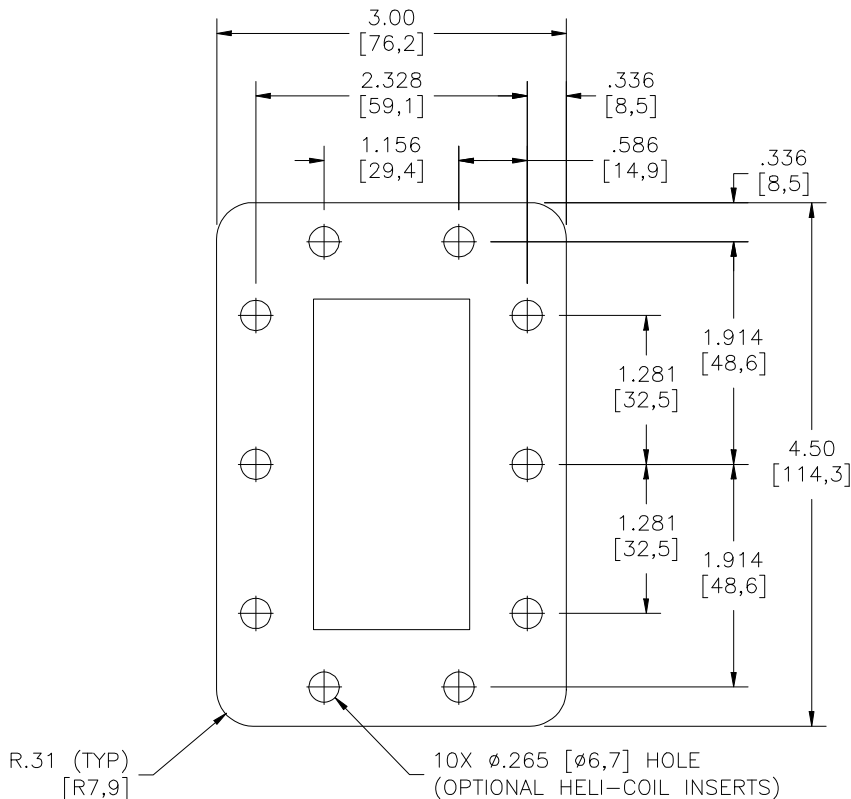
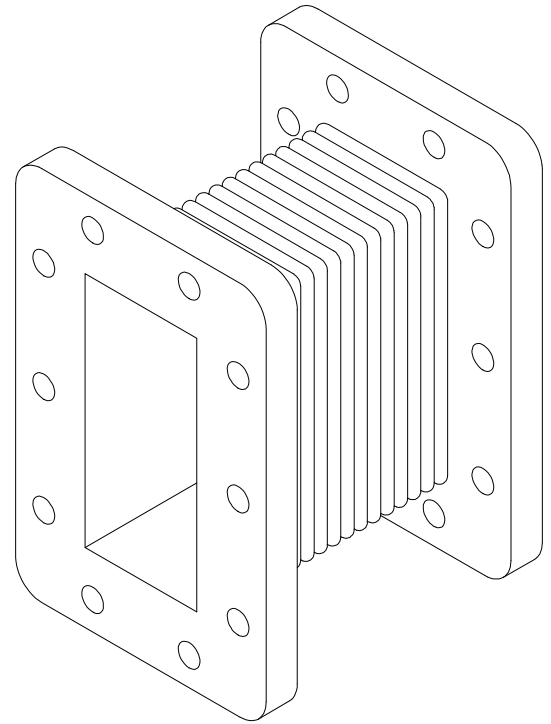

GERLING APPLIED
ENGINEERING, INC.

© 2003 Gerling Applied Engineering, Inc.
 PO Box 580816 • Modesto, CA 95358 • USA
 Phone: +1-209-527-8960 • Fax: +1-209-527-5385
 E-mail: sales@2450MHz.com • Web: www.2450MHz.com